

AlphaNeb^{4.0}

Aerosol completo ed efficace
Complete and effective nebuliser

Treatment targeted to the
upper and lower airways
with the RF9 nebuliser
Targeted upper and
lower airways treatment
With the RF9 nebuliser

4 tipologie di nebulizzazione
4 modes of nebulization

ALTE VIE / UPPER AIRWAYS

LOWER AIRWAYS / BASSE VIE



Free Flow



REGIONE OROFARINGEA /
OROPHARYNGEAL
REGION

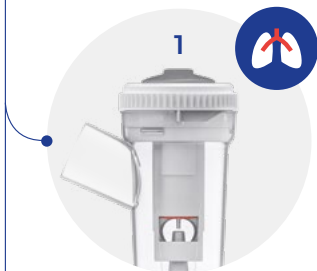

1
REGIONE TRACHEO-
BRONCHIALE /
TRACHEO-
BRONCHIAL
REGION

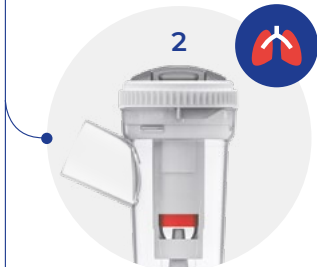

2
REGIONE
POLMONARE /
PULMONARY
REGION

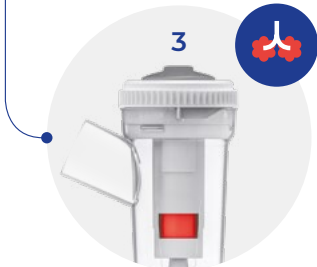

3
REGIONE
PERIFERICA /
PERIPHERAL
REGION



Terapia respiratoria completa
Complete respiratory therapy

MADE
IN ITALY

AlphaNeb 4.0



MD

Dispositivo Medico per la somministrazione di farmaci tramite inalazione, la cui terapia inalatoria e i farmaci devono essere prescritti dal Medico / Medical Device for the administration of drugs by inhalation, whose inhalation therapy and drugs must be prescribed by the Doctor







-  **Made in Italy**
-  **Confortevoli mascherine Soft Touch adulto e pediatriche / Comfortable adult and paediatric Soft Touch masks**
-  **Ampolla RF9 a 4 velocità e granulometria variabile / RF9 nebuliser with 4 speed and variable particle size**
-  **Filtro dell'aria ad alta efficienza / High efficiency filter**

Specifiche tecniche / Technical Features

Uso / Use	Continuo / Continuous	
Alimentazione / Power supply-Power	230V ~ 50Hz / 130VA	
Filtraggio aria / Air filtering	Per una maggiore qualità, l'aria compressa viene aspirata dall'ambiente esterno e filtrata con un sistema ad alta efficienza / For better quality, the compressed air is taken external of the housing and filtered using a high efficiency filter	
Flusso aria / Compressor air output	9 l/min (approx)	
Pressione massima / Max pressure	1.8 ± 0.3 bar / 26.1 ± 4.35 psi	
Rumorosità (a 1 m) / Sound level (at 1 m)	55 dB (A) APPROX	
Dimensioni / Dimensions	18 x 19 x 13 cm (L x P x H)	
Peso / Weight	1,3 Kg	
Approvazioni / Approvals	Conforme al Regolamento 2017/475 UE "Dispositivi Medici" e successive modifiche / In compliance with EU 2017/745 Medical Device Regulation and subsequent amendments	
	Esente da ftalati. In conformità a: Reg. (CE) n. 1907/2006 / Phthalates free. In conformity with Reg. (EC) no. 1907/2006	
	In compliance with std. EN 60601-1 and EN 60601-1-11 (for the 230V ~ 50Hz unit only) / Conforme alla Norma EN 60601-1 e EN 60601-1-11 (solo per unità 230V ~ 50Hz)	

Caratteristiche tecniche ampolla / Nebulization technical features

Tratto respiratorio / Respiratory System		Configurazione ampolla / Nebulizer configuration	MMAD (µm)	Output rate (ml/min) ⁽¹⁾
Alte vie / Upper Airways	Tratto orofaringeo / Oropharyngeal region 	Senza selettore / No selector	7.71 ⁽³⁾	0.53 ⁽²⁾
Basse vie / Lower Airways	Tratto tracheo-bronchiale / Tracheo bronchial region 	Posizione 1 / Position 1	5.12 ⁽¹⁾	0.36 ⁽²⁾
	Tratto polmonare / Pulmonary region 	Posizione 2 / Position 2	3.67 ⁽¹⁾	0.30 ⁽²⁾
	Tratto periferico / Peripheral region 	Posizione 3 / Position 3	2.49 ⁽¹⁾	0.23 ⁽²⁾



⁽¹⁾ Dati rilevati secondo procedura interna Flaem. I valori di velocità di erogazione possono variare in funzione della capacità respiratoria del paziente / Data shown according with Flaem Nuova internal procedure. Values shown for the aerosol delivery may vary depending on the patients respiratory capacity.

⁽²⁾ Caratterizzazione in vitro eseguita da TÜV Rheinland Italia S.r.l. in collaborazione con l'Università di Parma. Maggiori dettagli sono disponibili a richiesta / In vitro testing performed by TÜV Rheinland Italia S.r.l. in collaboration with the University of Parma. More details are available on request.

⁽³⁾ Dati calcolati dai valori ottenuti con Malvern Spraytec e comparati con i valori dei test eseguiti dall'Università di Parma / Data calculated based on the values obtained with the Malvern Spraytec and compared with the values of the tests performed at UNI Parma.

Accessori / Accessories

- Ampolla RF9 con sistema valvolare / RF9 nebulizer with valve system
- Boccaglio con valvola / Mouthpiece with valve
- Nasale adulto e pediatrico / Adult and pediatric nose piece
- Maschera Soft Touch Adulto / Soft Touch Adult mask
- Maschera Soft Touch Pediatrica / Soft Touch Child mask
- Tubo connessione 1 mt / 1 m connection tube

AlphaNeb 4.0

Codice / Code	AN13P00
Modello / Model	P0707EM F400 + RF9-1
Imballo / Master carton	8 pezzi / 8 pieces

